



An Ingersoll Rand Business



FLOMAX 8 Hydraulic

2" x 2" Self Priming Centrifugal Pump

The FLOMAX® 8 Hydraulic Self-Priming Centrifugal Pump is engineered for demanding industrial, agricultural, and marine environments, delivering high performance and reliability. It generates enough vacuum to lift liquids from depths of up to 25 feet (7.6 m), ensuring smooth and efficient priming. Once primed, its integrated flapper valve retains a full liquid column in the suction line, preventing loss of prime and supporting uninterrupted operation.

This model can be equipped with gerotor motors offering displacements of .37, .45 or .58 cu. in. (6.1, 7.4 and 9.5 cm³). These configurations accommodate hydraulic flow rates between 5 GPM (1.1 m³/h) and 12 GPM (2.7 m³/h), with operating pressures ranging from 900 PSI (62 bar) to 1850 PSI (128 bar). Such flexibility makes the pump adaptable to a wide variety of applications.

Built for durability, the FLOMAX® 8 incorporates a stainless steel drive sleeve and fasteners for superior resistance to wear and corrosion. A renewable wearplate simplifies maintenance and prolongs service life, while the semi-open, dynamically balanced impeller minimizes vibration and enhances efficiency.

For operations involving abrasive or corrosive fluids, optional upgrades include double grease-lubricated seals and stainless steel impellers and seals, ensuring reliable performance in harsh conditions.

SPECIFICATIONS:

Suction / Discharge	2" x 2" NPT ports
Materials of Constructions	316 stainless steel, Aluminum, Bronze, Cast iron
Flow	Up to 200 GPM (45.4 m ³ /h)
Head Feet	Up to 275' (83.8 m)
Impeller	5.0" (127 mm) semi-open
Seal	Special seal material combinations available (consult factory), Standard carbon / ceramic / Viton
Drive Options	Hydraulic motor .37 cu. in. (6.1 cm ³) Hydraulic motor .45 cu. in. (7.4 cm ³) Hydraulic motor .58 cu. in. (9.5 cm ³)
Max Solid Size	.56" (14.2 mm) diameter
Hydraulic Fluid Flow	Up to 12 GPM (2.7 m ³ /h)
Hydraulic System Pressure	Up to 1900 psi (131 bar)
Hydraulic Motor	Gerotor
PSI / bar	Up to 120 PSI / 8.3 bar
Option	Hydraulic motors with flow control

Features

- Renewable wear plate
- Stainless steel drive sleeve
- Stainless steel fasteners
- Up to a 25' (7.6 m) suction lift
- ABS Type Approved

Application

- Agricultural
- Industrial
- Marine



12500 South Pulaski Road
Alsip, IL 60803, USA
Phone (800) 563-8006



An Ingersoll Rand Business

FLOMAX 8 Hydraulic

PERFORMANCE CURVES

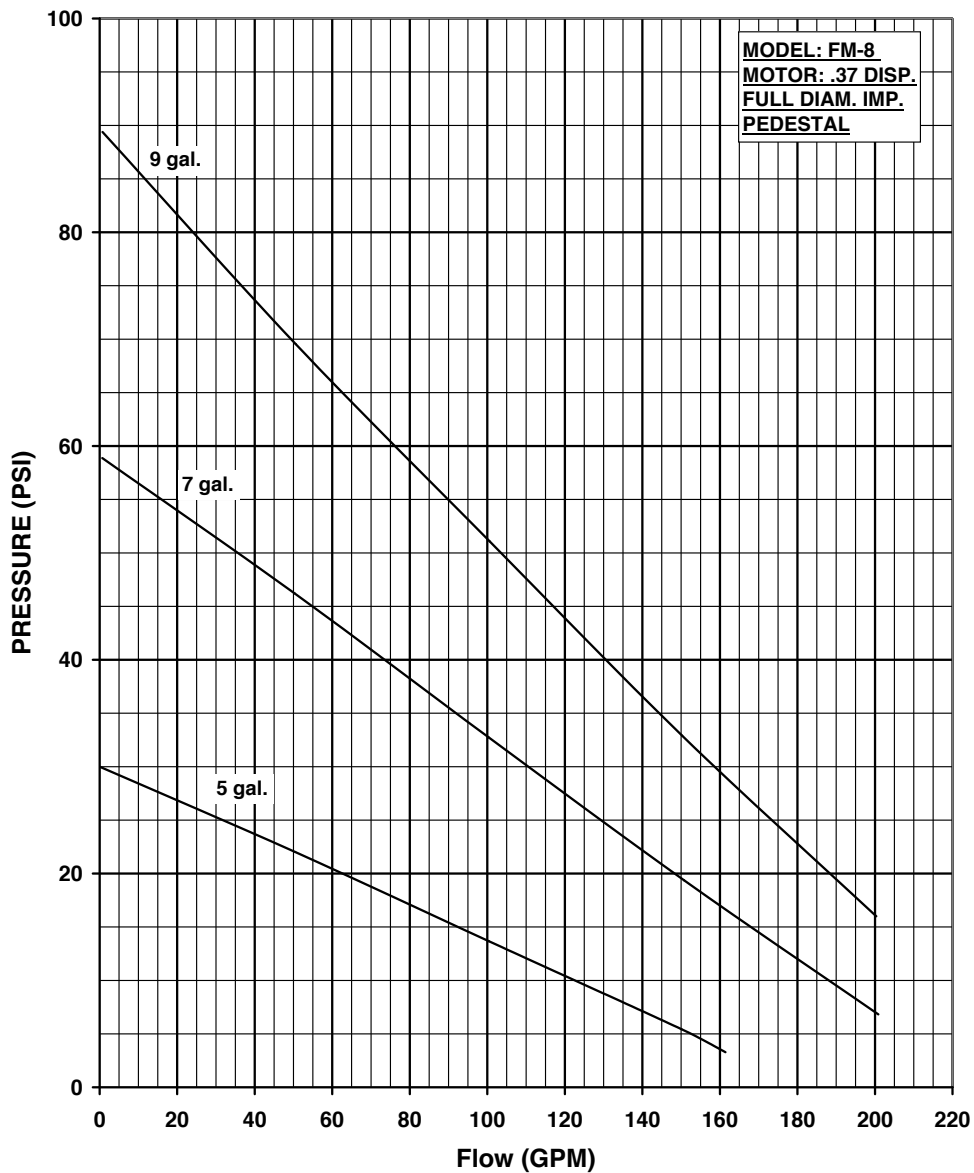

OIL FLOW	SHUT OFF	20	40	60	80	100	120	140	160	180	200	MAX. HYD. OIL PRESS. REQ.
	0 GPM	GPM	GPM	GPM	GPM	GPM	GPM	GPM	GPM	GPM	GPM	
5 GPM	30 PSI	27 PSI	24 PSI	21 PSI	17 PSI	14 PSI	11 PSI	7 PSI	4 PSI			920 PSI
7 GPM	59 PSI	54 PSI	49 PSI	43 PSI	37 PSI	33 PSI	27 PSI	22 PSI	17 PSI	12 PSI	7 PSI	1460 PSI
9 GPM	89 PSI	82 PSI	74 PSI	66 PSI	57 PSI	49 PSI	42 PSI	38 PSI	29 PSI	23 PSI	17 PSI	1850 PSI

CN 7090-S



12500 South Pulaski Road
Alsip, IL 60803, USA
Phone (800) 563-8006



An Ingersoll Rand Business

FLOMAX 8 Hydraulic

PERFORMANCE CURVES

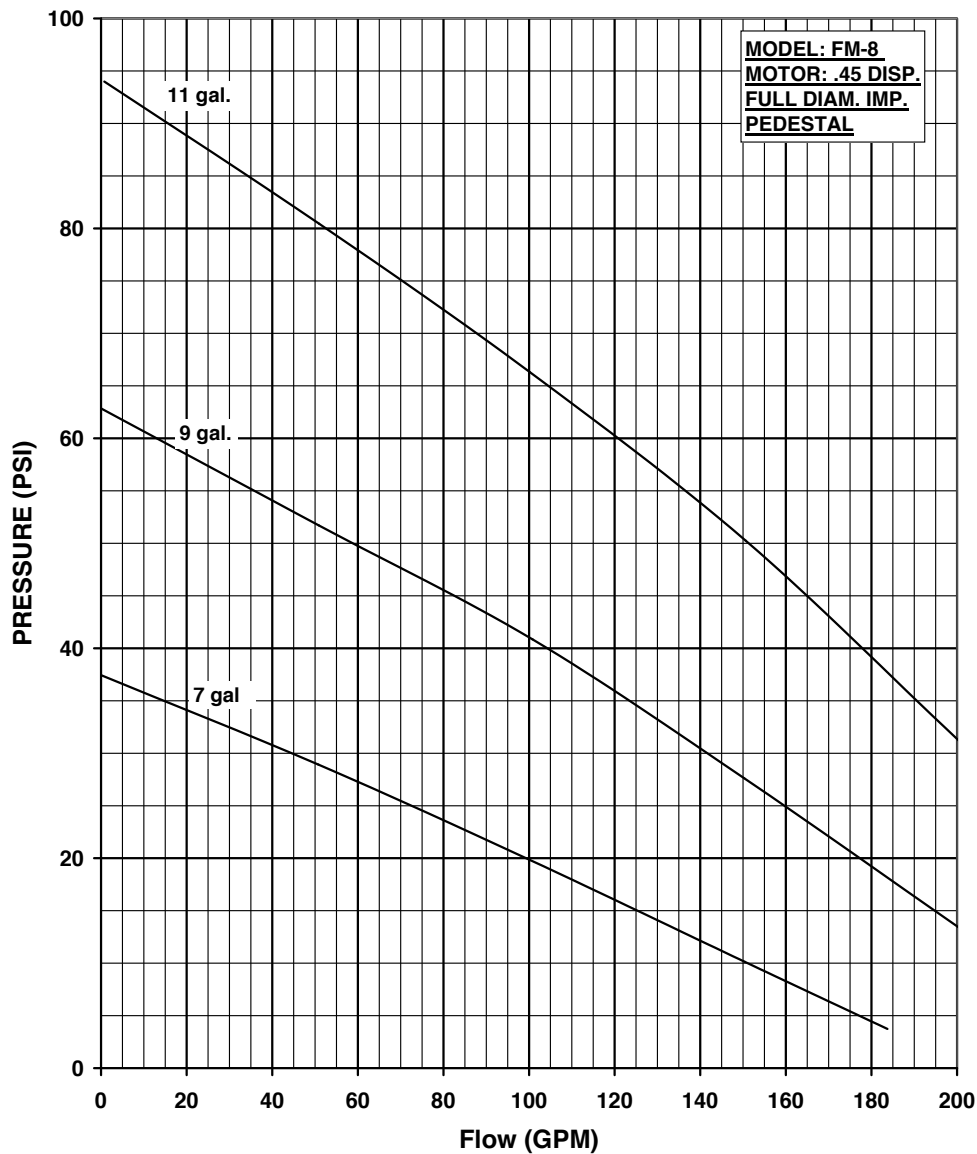

OIL FLOW	SHUT OFF	20	40	60	80	100	120	140	160	180	200	MAX. HYD. OIL PRESS. REQ.
	0 GPM	GPM	GPM	GPM	GPM	GPM	GPM	GPM	GPM	GPM	GPM	
7 GPM	37 PSI	34 PSI	31 PSI	27 PSI	24 PSI	20 PSI	16 PSI	13 PSI	8 PSI	4 PSI		900 PSI
9 GPM	62 PSI	58 PSI	54 PSI	50 PSI	46 PSI	41 PSI	36 PSI	31 PSI	25 PSI	19 PSI	14 PSI	1400 PSI
11 GPM	94 PSI	89 PSI	83 PSI	78 PSI	72 PSI	66 PSI	60 PSI	54 PSI	46 PSI	37 PSI	29 PSI	1920 PSI

CN 7091-S



12500 South Pulaski Road
 Alsip, IL 60803, USA
 Phone (800) 563-8006



An Ingersoll Rand Business

FLOMAX 8 Hydraulic

PERFORMANCE CURVES

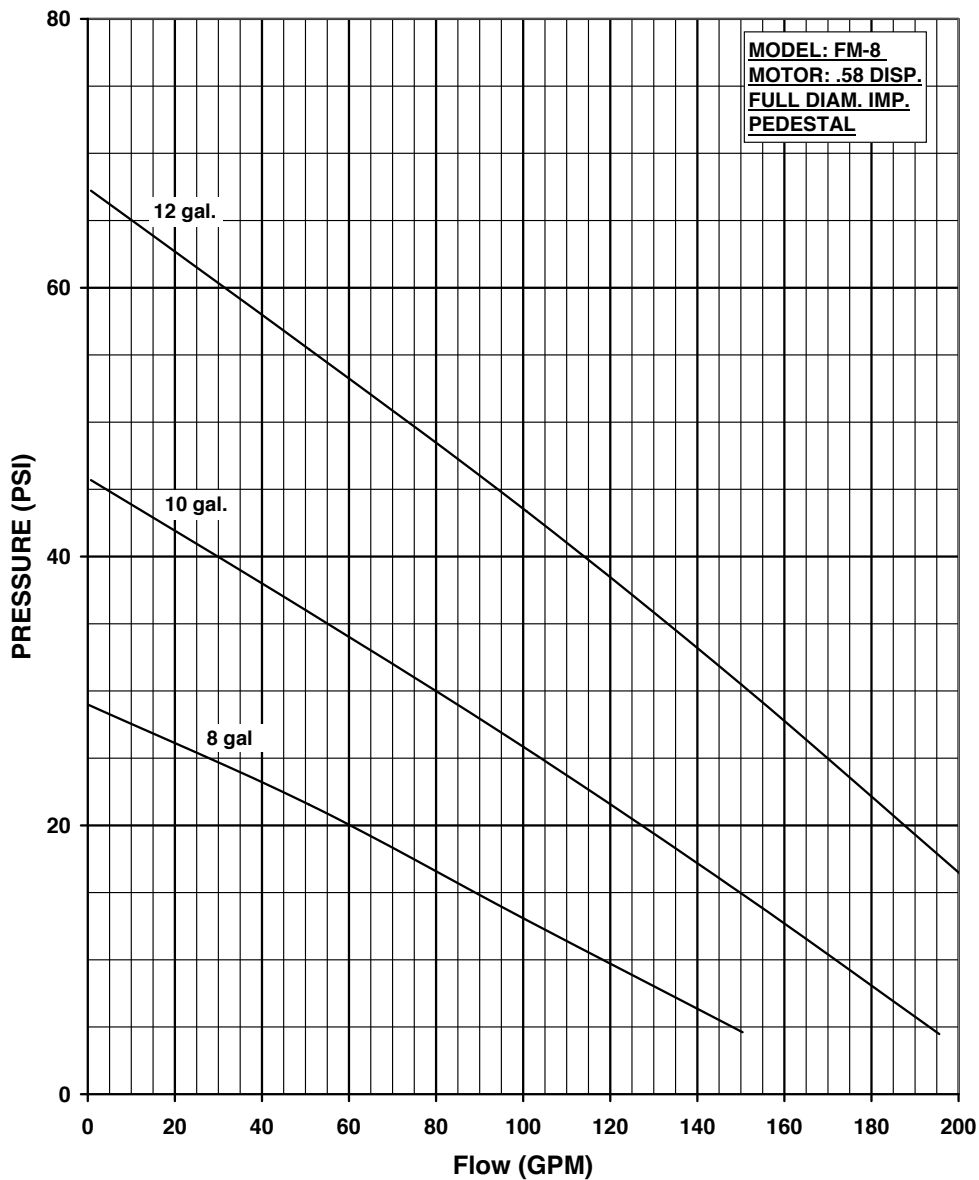

OIL FLOW	SHUT OFF	20	40	60	80	100	120	140	160	180	200	MAX. HYD. OIL PRESS. REQ.
	0 GPM	GPM	GPM	GPM	GPM	GPM	GPM	GPM	GPM	GPM	GPM	
8 GPM	29 PSI	26 PSI	23 PSI	20 PSI	16 PSI	13 PSI	10 PSI	6 PSI				650 PSI
10 GPM	46 PSI	42 PSI	38 PSI	34 PSI	30 PSI	26 PSI	22 PSI	17 PSI	13 PSI	8 PSI		900 PSI
12 GPM	67 PSI	63 PSI	58 PSI	54 PSI	48 PSI	43 PSI	38 PSI	33 PSI	27 PSI	23 PSI	17 PSI	1300 PSI

CN 7092-S



12500 South Pulaski Road
Alsip, IL 60803, USA
Phone (800) 563-8006



An Ingersoll Rand Business

FLOMAX 8 Hydraulic

PERFORMANCE CURVES

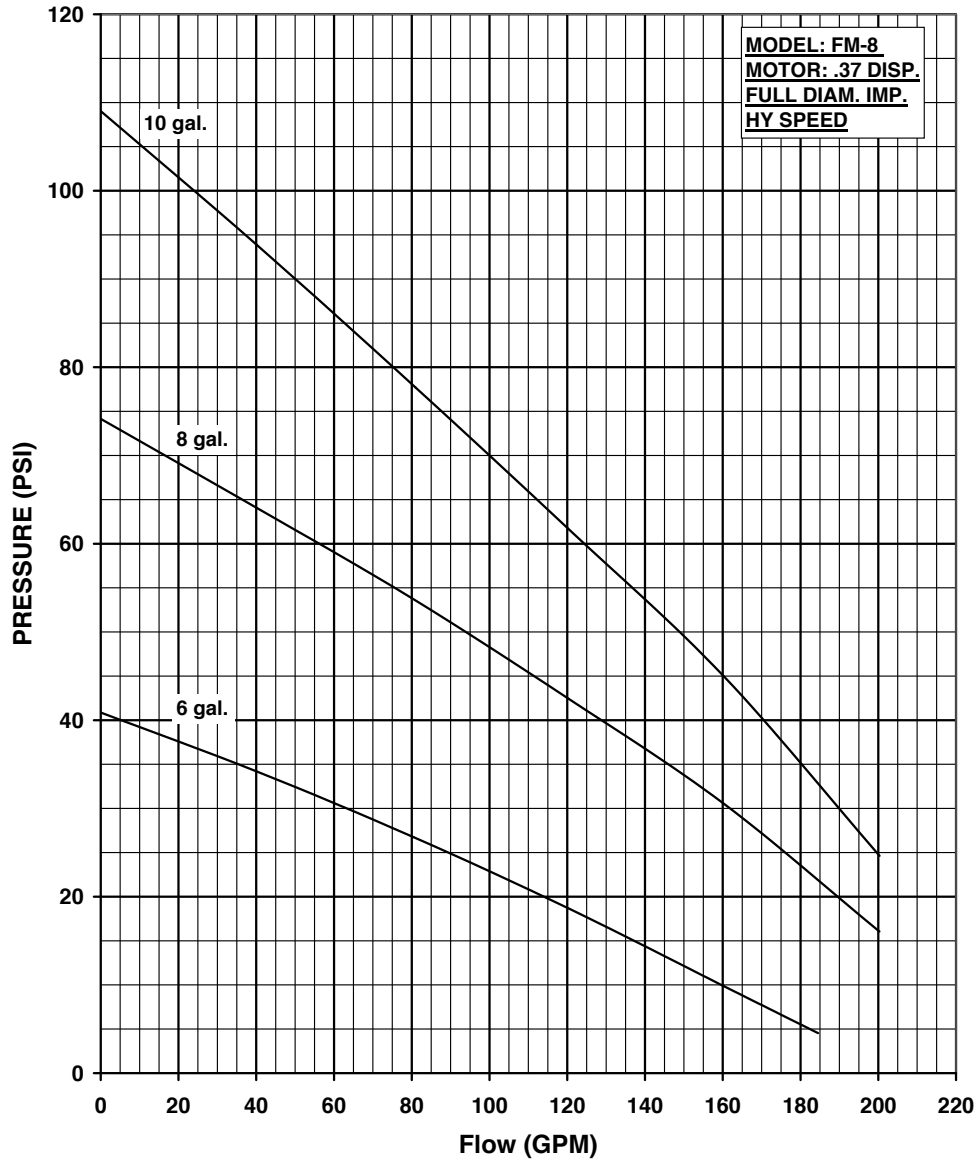

OIL FLOW	SHUT OFF 0 GPM	20 GPM	40 GPM	60 GPM	80 GPM	100 GPM	120 GPM	140 GPM	160 GPM	180 GPM	200 GPM	MAX. HYD. OIL PRESS. REQ.
6 GPM	41 PSI	38 PSI	34 PSI	31 PSI	27 PSI	22 PSI	18 PSI	14 PSI	10 PSI	5 PSI		1250 PSI
8 GPM	74 PSI	69 PSI	64 PSI	59	54 PSI	48 PSI	43 PSI	37 PSI	31 PSI	24 PSI	16 PSI	1950 PSI
10 GPM	109 PSI	102 PSI	94 PSI	86 PSI	78 PSI	70 PSI	62 PSI	54 PSI	45 PSI	35 PSI	25 PSI	2350 PSI

CN 7093-S



12500 South Pulaski Road
 Alsip, IL 60803, USA
 Phone (800) 563-8006



An Ingersoll Rand Business

FLOMAX 8 Hydraulic

PERFORMANCE CURVES

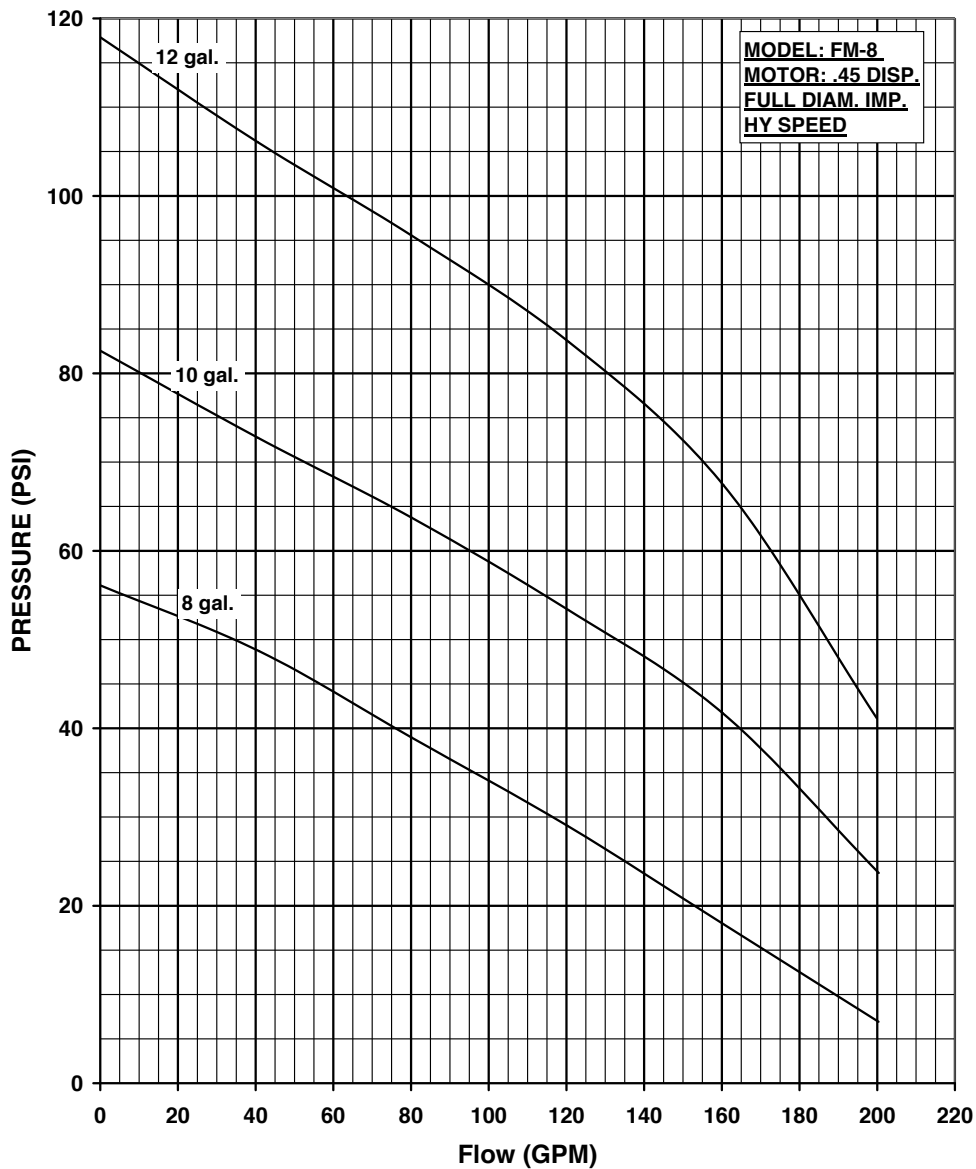

OIL FLOW	SHUT OFF	20	40	60	80	100	120	140	160	180	200	MAX. HYD. OIL PRESS. REQ..
	0 GPM	GPM	GPM	GPM	GPM	GPM	GPM	GPM	GPM	GPM	GPM	
8 GPM	53 PSI	49 PSI	44 PSI	41 PSI	37 PSI	33 PSI	28 PSI	24 PSI	18 PSI	14 PSI	8 PSI	1250 PSI
10 GPM	82 PSI	77 PSI	73 PSI	68 PSI	64 PSI	59 PSI	54 PSI	48 PSI	42 PSI	34 PSI	24 PSI	1850 PSI
12 GPM	118 PSI	110 PSI	105 PSI	100 PSI	96 PSI	90 PSI	83 PSI	76 PSI	67 PSI	54 PSI	37 PSI	2450 PSI

CN 7094-S



12500 South Pulaski Road
 Alsip, IL 60803, USA
 Phone (800) 563-8006



An Ingersoll Rand Business

FLOMAX 8 Hydraulic

PERFORMANCE CURVES

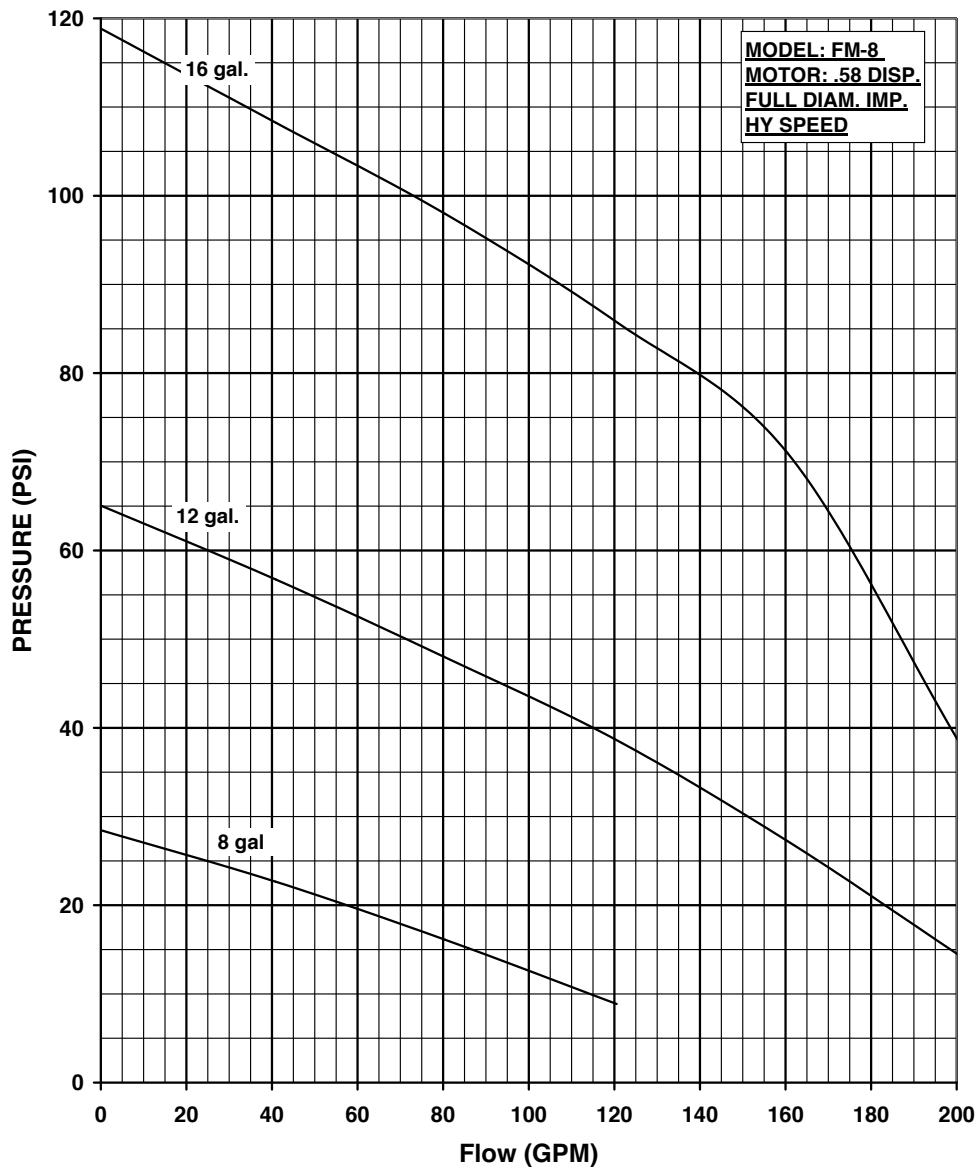

OIL FLOW	SHUT OFF	20	40	60	80	100	120	140	160	180	200	MAX. HYD. OIL PRESS. REQ..
	0 GPM	GPM	GPM	GPM	GPM	GPM	GPM	GPM	GPM	GPM	GPM	
8 GPM	28 PSI	26 PSI	23 PSI	20 PSI	16 PSI	13 PSI	9 PSI					650 PSI
12 GPM	65 PSI	61 PSI	56 PSI	53 PSI	48 PSI	43 PSI	38 PSI	44 PSI	27 PSI	21 PSI	15 PSI	1250 PSI
16 GPM	119 PSI	113 PSI	106 PSI	102 PSI	98 PSI	93 PSI	86 PSI	80 PSI	72 PSI	56 PSI	39 PSI	1950 PSI

CN 7095-S



12500 South Pulaski Road
 Alsip, IL 60803, USA
 Phone (800) 563-8006



An Ingersoll Rand Business

FLOMAX 8 Hydraulic

DIMENSIONS

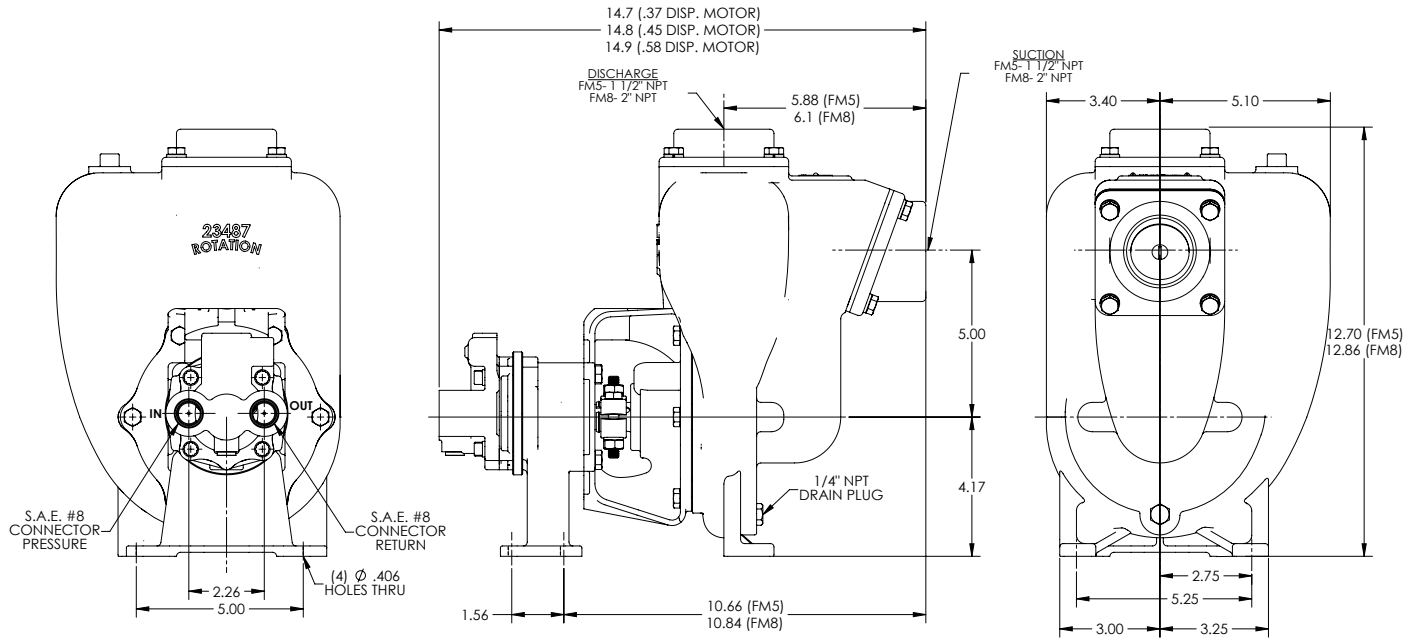

* For complete parts lists and troubleshooting guidance, please refer to the MP Pumps Installation Operation & Maintenance (IOM) Manual.



12500 South Pulaski Road
Alsip, IL 60803, USA
Phone (800) 563-8006