

2110Z Series

FEATURES

- > Oil-less operation
- > Permanently lubricated bearings
- > Stainless steel valves
- > High performance piston seal
- > Magnesium or Aluminum die-cast components
- > Corrosion resistant wetted parts
- > Dynamically balanced
- > Brushless DC motor
- > RoHS/Reach compliant

TYPICAL APPLICATIONS

- > Portable Oxygen Concentrator
- > Small Analytical Equipment
- > Instrumentation
- > Ambient Scenting
- > Lab Automation

CUSTOMER REQUIREMENTS

- > Supplemental cooling air flow to compressor to be integrated into thermal management system to ensure that proper installation and operating environment is maintained in keeping with the product specifications
- > BLDC motor requires motor controller - SKCNTLR optional Thomas controller available in sample quantities

BASE MODEL



2110ZA26/12M
2110ZA26/12



2110ZA26/12M
Magnesium Die Cast Components

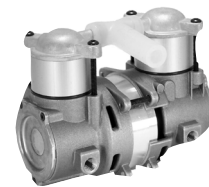

2110ZA26/12
Aluminum Die Cast Components



WOB-L®

2110Z Series

Flow	0.50 cfm (14.1 l/min)
Max. pressure	30 psig (2.1 bar)
Max. vacuum	N/A Pressure Only



2110ZA26/12M
Magnesium Die Cast
Components



2110ZA26/12
Aluminum Die Cast
Components

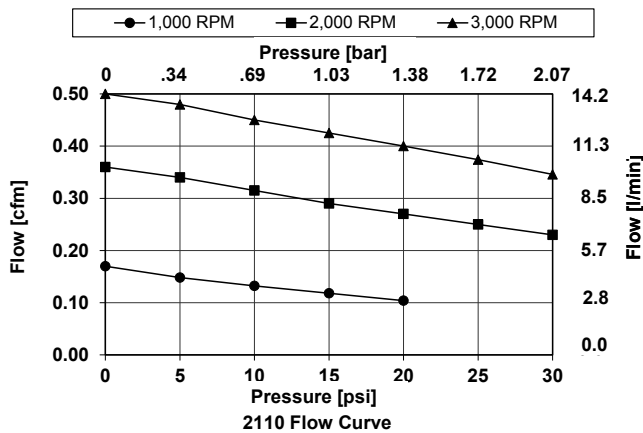

PERFORMANCE DATA

Model Number	2110ZA26/12M (Mg Version) OR 2110ZA26/12 (Al Version)		
Head Configuration	Pressure parallel flow		
Stroke	0.26 in. (6.6 mm)		
Nominal voltage input	12V DC	12V DC	12V DC
Variable output speed	1,000 rpm	2,000 rpm	3,000 rpm
Max. open air flow	0.17 cfm (4.8 l/min)	0.34 cfm (9.6 l/min)	0.50 cfm (14.1 l/min)
Max. rated pressure	20 psi (1.4 bar)	30 psig (2.1 bar)	30 psig (2.1 bar)
Current at rated pressure	2.6A	3.9A	4.8A
Power at rated pressure	32W	47W	58W
Max. pressure restart	20 psig (1.4 bar)	30 psig (2.1 bar)	30 psig (2.1 bar)
Max. vacuum	Not available	Not available	Not available
Max. vacuum restart	Not available	Not available	Not available

ELECTRICAL DATA

Motor type	8 pole brushless DC, 3 phase
Motor insulation class	155°C maximum winding temperature
Motor protection	Not included - Customer to integrate into system controller
	Optional SKCNTLR Thomas controller disables motor for stall, temperature, & amps
Power lead wire color, gauge	Green (phase A), black (phase B), red (phase C), 22 AWG
Hall sensor wire color, gauge	Yellow (+VDC), brown (HS1), orange (HS2), blue (HS3), gray (ground), 22 AWG

GENERAL DATA

Operating ambient temperature	50° TO 104° F (10° to 40°C)*
Safety Certification	Consult factory
Net weight	2110ZA26/12M (Mg version) = 0.72 lbs (325g) OR 2110ZA26/12 (Al version) = 0.85 lbs (387g)

*Broader ambient operating ranges may be possible depending on your specific application. Please consult factory regarding your particular system needs.

PRODUCT DIMENSIONS

2110ZA26/12



Dimensions in in [mm]

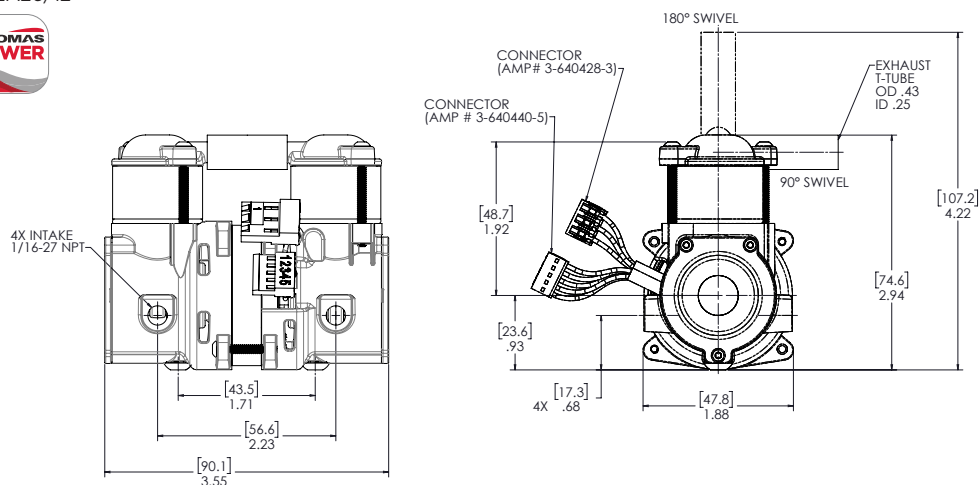

NOTE:

EXHAUST T-TUBE IS COMPRISED OF FLEXIBLE SILICONE RUBBER AND HAS THE ABILITY TO SWIVEL ABOUT HEAD BARBED FITTINGS.

UNIT REQUIRES SUPPLEMENTAL COOLING AIR FLOW.

BRUSHLESS DC TECHNOLOGY REQUIRES MOTOR CONTROLLER TO OPERATE.

LEAD CONFIGURATION:
HALL SENSOR: 11.50 ±0.50
POSITION 1 - YELLOW
POSITION 2 - BROWN
POSITION 3 - ORANGE
POSITION 4 - BLUE
POSITION 5 - GRAY

LINE: 11.50 ±0.50
POSITION 1 - GREEN
POSITION 2 - BLACK
POSITION 3 - RED

PUMP AND COMPRESSOR SOLUTIONS FOR OEMS WORLDWIDE

thomaspumps.com



Gardner Denver Thomas GmbH

Livry-Gargan-Str. 10
82256 Fürstentfeldbruck
Germany
T +49 8141 2280 0
F +49 8141 8892136
thomas.de@irco.com

Gardner Denver Thomas Pneumatic Systems (Wuxi) Co. Ltd.

1 New Dong'an Road, Shuofang Town
Xinwu District, Wuxi
Jiangsu, 214142 China
T +86 510 6878 2258
F +86 510 6878 2200
thomas.cn@irco.com



Gardner Denver Thomas, Inc.

1419 Illinois Avenue
Sheboygan, WI 53081
USA
T +1 920 4574891
F +1 920 4514276
td.usa@irco.com

The information presented in this material is based on technical data and test results of nominal units. It is believed to be accurate and reliable and is offered as an aid to help in the selection of Thomas products. It is the responsibility of the user to determine the suitability of the product for the intended use and the user assumes all risk and liability in connection there with. Thomas does not warrant, guarantee or assume any obligation or liability in connection with this information.

Models presented in this catalog are representative of the product family. Photos of products pictured in this catalog do not necessarily represent a specific model number. To obtain further information for custom options, contact your local Thomas office.

Printed in U.S.A Form No. 850-4020 09/2019 © Gardner Denver Thomas, Inc. All rights reserved.