

66975 CYCLE COUNTER KIT FOR DIAPHRAGM PUMPS

RELEASED: 5-24-93
REVISED 7-31-20
(REV: D)

GENERAL DESCRIPTION

Kits include parts to adapt the Cycle Counter to all Metallic and Non-metallic 1/2", 1", or 1-1/2" diaphragm pumps or only 2" Non-metallic diaphragm pumps.
Not all the parts will be used.

Two counter support brackets are included and either one can be used depending on the application. Fig. 1 shows the counter extended from the pump (this will fit most applications). Fig. 2 shows the inboard counter position which can be used on the larger 1-1/2" Metallic and Non-metallic pumps and only 2" Non-metallic pumps.

New Y6-45-C screws are provided, these longer screws must be used to accommodate the threaded adapter plate (93911).

INSTALLATION

1" METALLIC DIAPHRAGM PUMPS ONLY (see fig.1)

NOTE: Refer to the pump Operator's Manual

1. On the air inlet side of the pump remove the four Y6-42-C screws, 92003 leg and 92878 gasket.
 2. The leg of a 1" Metallic Diaphragm Pump must be modified. Use the 93913 template included as a guide. (Drill a 1/2" hole).
 3. Replace the old 92878 gasket with new 92878 gasket provided in the kit.
 4. Position the modified leg.
 5. Place the 92004 gasket on the leg.
 6. Install the 93911 adapter plate with the 1/4 NPT tapered threads outward, secure the plate with Y6-45-C screws and the four previously used lock washers.
- NOTE:** The elbow cannot be installed if the plate is reversed.
7. Assemble the 59756-4 90° tubing elbow into the adapter plate.
 8. Remove one screw from the top manifold. Use the screw to attach the 93910 bracket to the manifold.
 9. Assemble the 59801 counter to the bracket using the screw, nut and washer (provided with the counter).
 10. Assemble signal tubing to counter input marked "Z" and to 59756-4 90° elbow. (Cut tubing as necessary).

1" METALLIC DIAPHRAGM PUMP

93913 TEMPLATE FOR USE WITH 1" METALLIC LEG

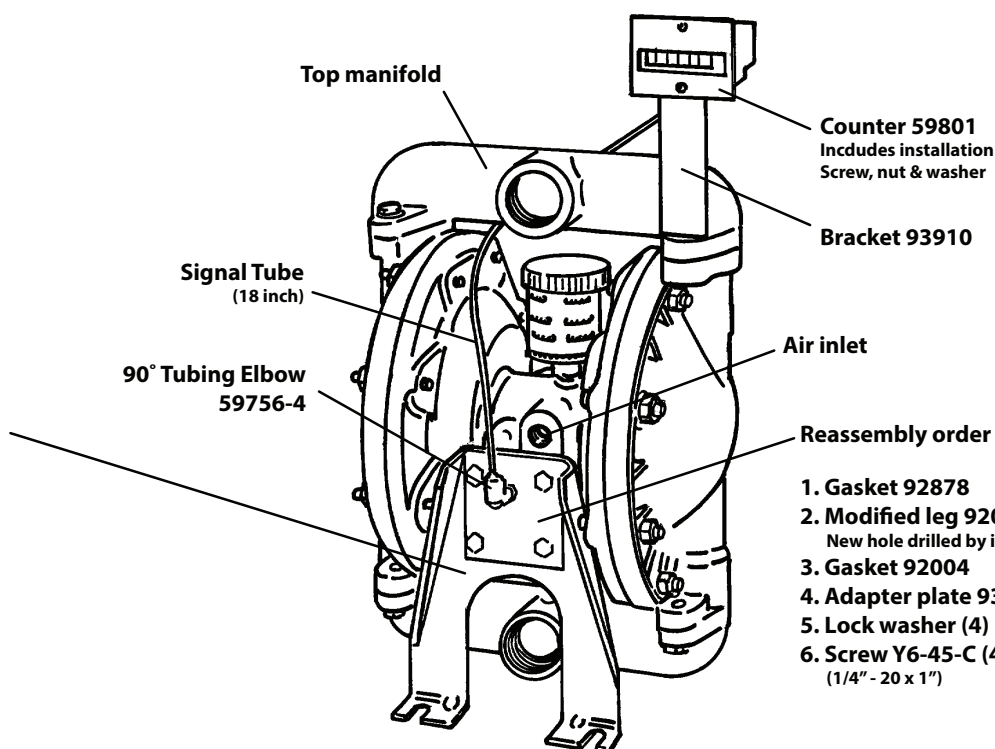
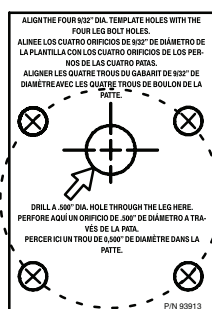

Figure 1

COUNTER KIT INSTALLATION FOR LARGE AND 1/2" DIAPHRAGM PUMPS

1" NON-METALLIC, 1-1/2" METALLIC AND NON-METALLIC AND ONLY 2" NON-METALLIC PUMPS

(see fig. 2)

NOTE: Refer to the pump Operator's Manual.

1. Remove four Y6-42-C screws and plate on the air inlet side of the pump.
2. Remove 92878 gasket, and ground lug.
3. Replace the old 92878 gasket with new 92878 gasket provided in the kit.
4. Install the 93911 adapter plate with the 1/4 NPT tapered threads outward, using screw location (b) in the figure below, secure the plate with two of the Y6-42-C screws and two of the previously used lock washers in the two lower screw holes.

NOTE: The elbow cannot be installed if the plate is reversed.

The following steps are for an inboard setup as shown in Fig 2.

5. Assemble the 59801 counter to the 93912 adapter plate using the screw, nut and washer (provided with the counter).
6. Attach the counter and adapter plate assembly using screw location (a) in the figure below, use the new Y6-45-C screws and the two remaining lock washers.
7. Assemble the 59756-4 90° elbow into the adapter.

The following steps are for top mounting similar to Fig 1. setup.

8. Use the Y6-42-C screws and two of the previously used lock washers in screw holes.
9. Assemble the 59801 counter to the 93910 bracket using the screw, nut and washer (provided with the counter).
10. Remove one screw from the top manifold, use the screw to attach the 93910 bracket to the manifold.
11. Assemble signal tubing to counter input marked "Z" and to 59756-4 90° elbow. (Cut tubing as necessary).

1/2" DIAPHRAGM PUMPS (No view shown)

NOTE: Refer to the pump Operator's Manual.

1. Remove the major valve retaining bolts Y6-419-T (4).
2. Remove the 93086 plug from the air motor major valve.
3. Install the new 93909 plug (with the threaded hole).
4. Reassemble the valve and replace the major valve bolts.
5. Install the 59756-4 90° elbow.
6. Remove one screw from the top manifold. Use the screw to attach the 93910 bracket to the manifold.
7. Assemble the 59801 counter to the 93910 bracket using the screw, nut and washer (provided with the counter).
8. Assemble the signal tubing to counter input marked "Z" and to 59756-4 90° elbow. (Cut tubing as necessary).

1-1/2" METALLIC DIAPHRAGM PUMP (Shown using the inboard mounting option)

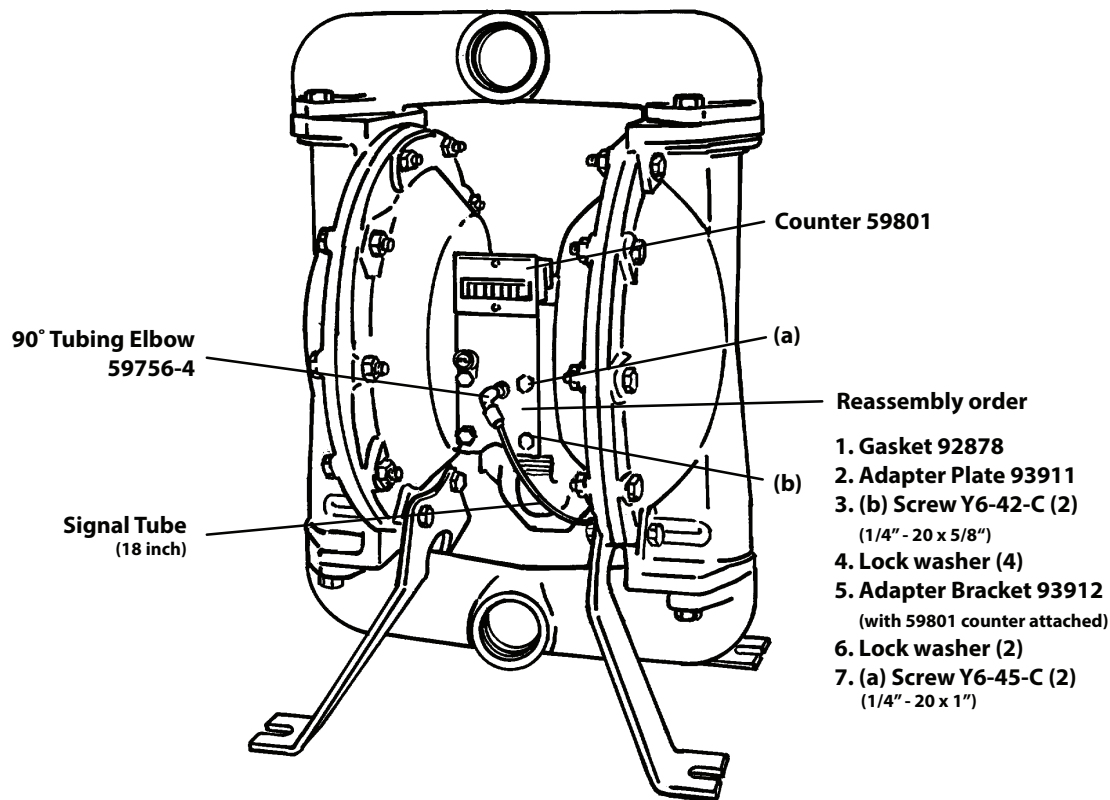

Figure 2